

Product Modle: PG-9025

Product Name: Bluetooth Controller



Telescopic stand
Maximum to support
5.5-inch phone



Introduction

This product is a new wireless Bluetooth controller which supports different android/ ios/ PC games.

- 1.It can be used when connected with the Bluetooth mobile phone and without any drivers.
- 2.Exclusive gaming application platform, the classic hand travel under control (ipega game lobby only for Android platform).
- 3.Built-in lithium battery (380mAh). After charging, it can be sustainable for 20 hours. Safe and stable.
4. With the telescopic stand, the phone can be put in the stand (maximum support for 5.5-inch mobile phone). Easy for playing games.
5. With "volume +, -, "last ", "next ""Play / Pause" , total 5 multimedia function keys (This function is imcompatible with Y key mode.)
- 6.Bluetooth 3.0 wireless transmission can support 6-8 meters wide range of control from the operation.
- 7.User-friendly software designed to enter the power saving mode with no connection state.
- 8.Support android 3.2, ios 4.3 above system.
- 9.Compatible with iPod/iPhone/iPad as well as the vast majority of android tablet PCs.

Game Support Description:

Under Android system, it supports the vast majority of games and simulator games (such as MC4, Wild blood, Dungeon Hunter, Zombie, FC simulator, GBA emulator, arcade emulator, SFC simulator, N64 emulator, Shadowgun, Sonic CD, Cordy, soulcraft, Zenonia4, 9 Innings 2013, Riptide GP, etc.)

Download method of games that are compatible: Enter itunes and App Store to search for "iCade". The handle can be compatibl e with the vast majority of games, such as Gunman Clive, Helium Boy, League of Evil League of Evil 2, Muffin Knight Free Stardash, Temple the Run and so on.

User Manual (操作说明)

X.GamePad Mode: Only Android 3.2 + versions supports this mode. When the handle is turned off, first press the "X" key, then press the HOME key. Bluetooth LED indicator flash. The handle enter into the pairing mode and turn on the phone and search for Bluetooth devices "ipega media gamepad controller" and pairing. If the pairing is successful, the LED indicator will be bright and the handle will be in the GamePad mode.

A.Keyboard Mode: When the handle is turned off, first press the "A" key, then press the HOME key. The Bluetooth LED indicator flash and the handle enter into pairing mode. Turn on the phone and search for Bluetooth devices "ipega media gamepad controller" and pairing. If the pairing is successful, the LED indicator will be bright and the handle will be in the keyboard mode.

B.iCade modes: When the handle is turned off, first press the "B" key, then press the HOME key. The Bluetooth LED indicator flash, and the handle enter into the pairing mode. Turn-in the phone and search for Bluetooth devices "ipega media gamepad controller" and pairing. If it is successful, the LED light will be bright and the handle will be in the iCade mode.

Download and use the ipega game lobby: Login the official forum: <http://www.aipaige.com> and download ipega game lobby APK file

- 1 Switch on the application "ipega game lobby" and then click to enter my device (Fig. 1)
- 2 When the handle is turned off, first press the "Y" key, then press the HOME button. The LED indicator light flash and the handle enter into the pairing state
- 3 Switch-in the Bluetooth, click Add handle search → "ipega media gamepad controller" → click interface to bind to jump to handle connection test program handles the connection is successful (Figures 1, 2)
- 4 Click Settings → Test Bitgames IME input method and check "Bitgames IME" → Select Input Method "Bitgames IME" → click Finish (Figure 3,4)

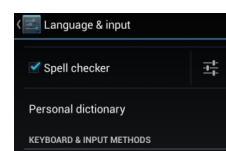
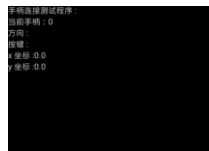

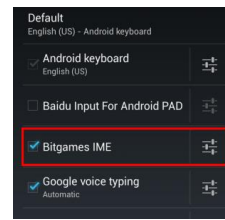

Y. SPP Mode: When the handle is turned off, first press the "Y" key, then press the HOME key. LED lights flash and the handle enters into the pairing mode. If the pairing is successful, the LED indicator is keeping bright. The handle is in the SPP mode; SPP mode requires corresponding Android APP software to complete the relevant key mapping function.

SPP use:

- 1 Go to Settings → Language and input → Select Input Method "GHTouch IM" (Figure 1)
- 2 Open the application "GHTouch" → Choose device "ipega media gamepad controller" → check "virtual screen buttons" → Select Input Method "GHTouch IM" → The device will automatically connect with the handle, after the connection is completed, the LED indicator light (Figures 2, 3)
- 3 After entering the game, press the volume up on the device or handle "Select" button, the button icon onto the screen corresponding to the position (Note: Double-click the icon to set the size), press return or click on the device handle "Select", icon hidden, complete the setup.

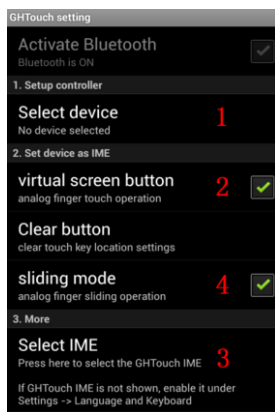
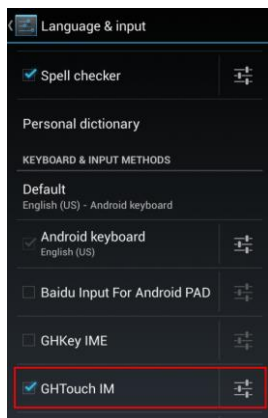

About input method setting: Using the controller to play game should set the phone or notebook input method to be default as English language input (For the ios system, be sure to switch the input method, and then pairing. If not, the handle does not work properly.)

Charging controller: Accessing the controller to 5V power supply for charging (PC device or mobile phone power adapter). In the process of charging, the charge indicator of the handle is orange and LED switched off when charging is completed.

Switch on/off the controller: Press "HOME" button for 3 seconds until the Bluetooth LED is off, it means shutdown is successful. If the phone is not unpair connection when controller shutdown. Just do it again. Press the "HOME" button for about five seconds, until the LED red light flashes slowly. It means that the handle is turned on (the default the last boot mode), the boot handle will automatically paired with the phone connection. If the connection fails, the handle will automatically shut down.

Connect the PC: Open the device's Bluetooth PC program, and select the "X, A" in either mode can be paired with (and does not have a Bluetooth PC devices need to use the Bluetooth receiver).

Note: To change the controller function mode, please turn off the controller firstly and cancel the bluetooth pairing, then in accordance with the operation mode to replace the steps.

Attention

1. When the controller can't operate normally, please use the paperclip to touch the reset switch on the left corner of the grip back when the grip cannot shut down or crash.
2. Please do not put this product in wet or hot place for storage.
3. Do not hit, beat, piercing or attempt to disassemble the product to avoid unnecessary damage.
4. Do not discard the built-in battery with garbage.
5. Do not use near fire or other heat source to recharge the battery.