

Product description

1 First, the Brief introduction of Beini router, familiar with every interface.

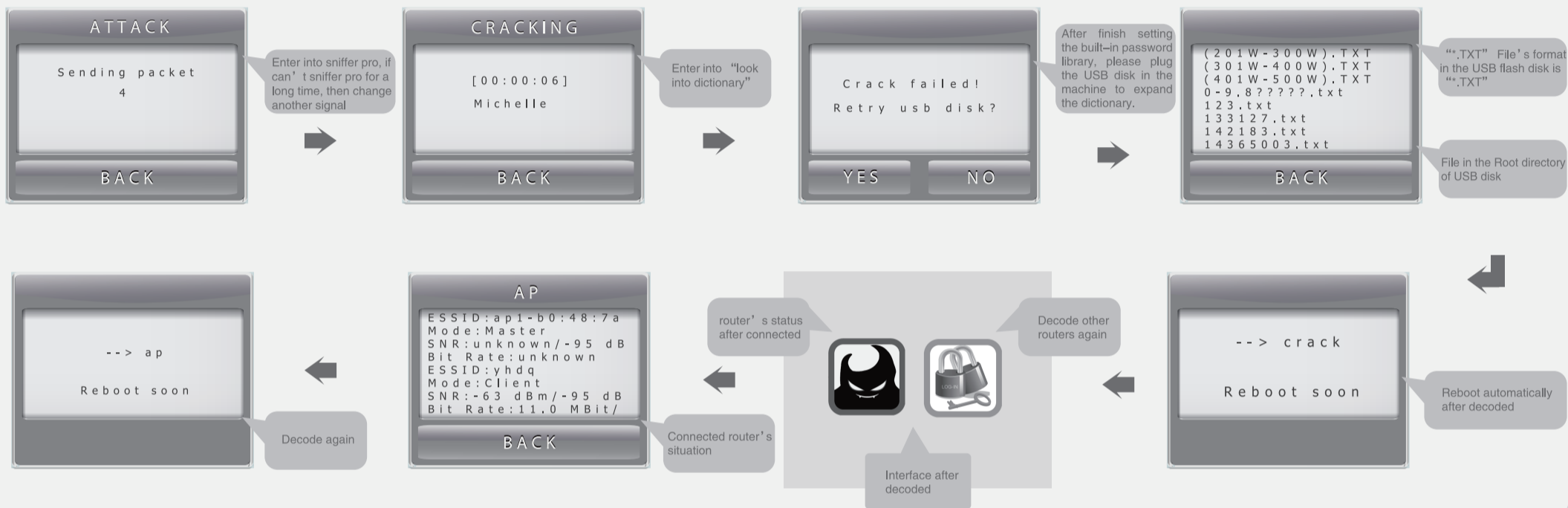
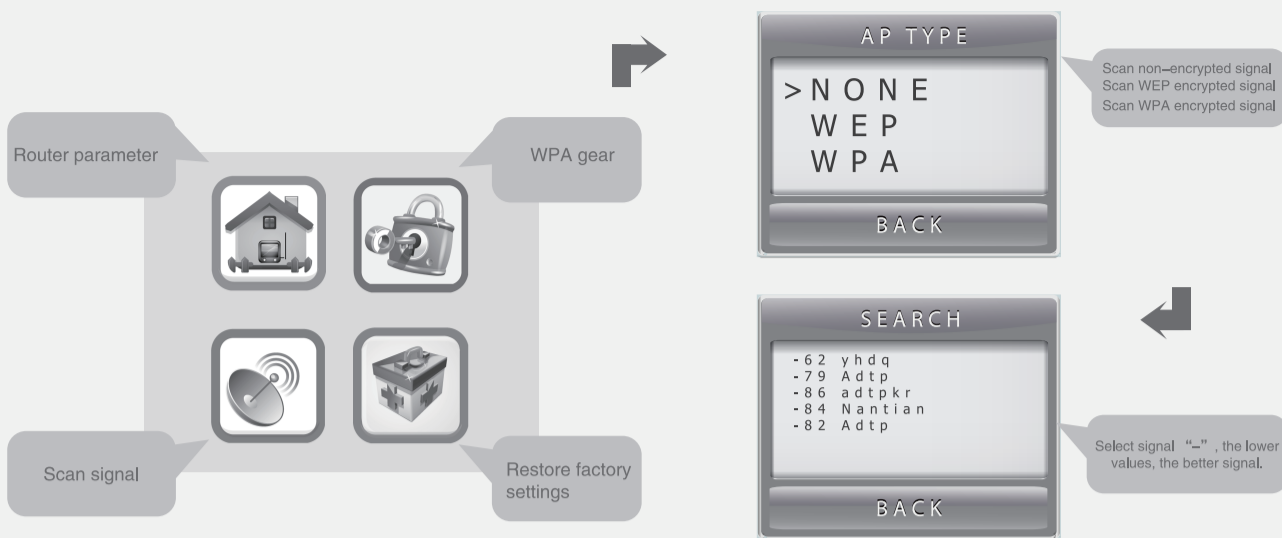

2 Second. Setting computer (Before setting, make sure your computer/Wi-fi cell phone/Tablet pc has installed wireless network card. Take Windows system for example to make specific description below)

Windows 7 Windows 7 system, please follow these steps to set.

- Click "Start" → "control panel" → "Network and Internet" → "Network and sharing center" → change the adapter setting → wireless network connecting → use right-hand button click "wireless network connecting", then select "Attribute".
- Click "TCP/IPv4"
- Select "obtain IP address automatically" and "Obtain DNS server address automatically". Click "Yes" → return to last interface, click "Yes".

Before the change, set the IP settings information backup.

Windows XP Windows 7 system, please follow these steps to set.

- Use right-hand button to click "Network neighborhood", select "Attribute".
- Use right-hand button to click "Wireless network connecting", select "Attribute".
- Click "TCP/IPv4"
- Select "obtain IP address automatically" and "Obtain DNS server address automatically". Click "Yes" → return to last interface, click "Yes".

Before the change, set the IP settings information backup.

3 Connect the wireless network. (It has to connect the wireless network successfully before login the Web manage page)

Windows 7 Windows 7 system, please follow these steps to set.

- After install the network card successfully, the icon will show on the bottom right of the desktop, please click the Icon.
- Please select the ideal wireless network from the network list, then click "Connect"
- When the menu shows "Connected" situation, it means computer has joined the wireless network successfully.

Windows XP Windows XP system, please follow these steps to set.

- After finished network card installation successfully, the Icon will show on the bottom right of desktop, please click the Icon.
- Click "Refresh network list", select the target wireless network from the network list, then click "Connect".
- When the network name shows the icon "connected", it means the computer has logged the wireless network.

Notice: the router's default Beini (wireless network name)
This router defaults never open wireless encryption. In order to protect the security of your wireless network, we strongly recommend you setting encryption on "step 4 setting router"

4 Set the router's interface

1 Open the browser, in the address bar, please input 192.168.110.1, then click "Enter key", after that, User name: root, Password: admin. Then click "Yes".



2 Enter the main interface, can set the color of the interface.



Interface 3-5

3 Click "Network Network" to set Wan

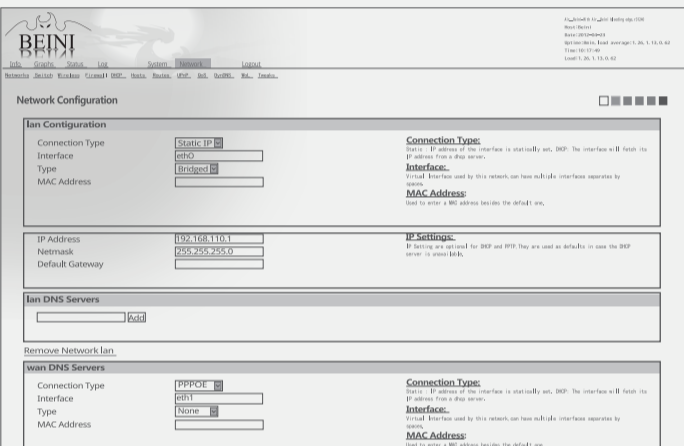

4 Set dial pattern, account password and so on.

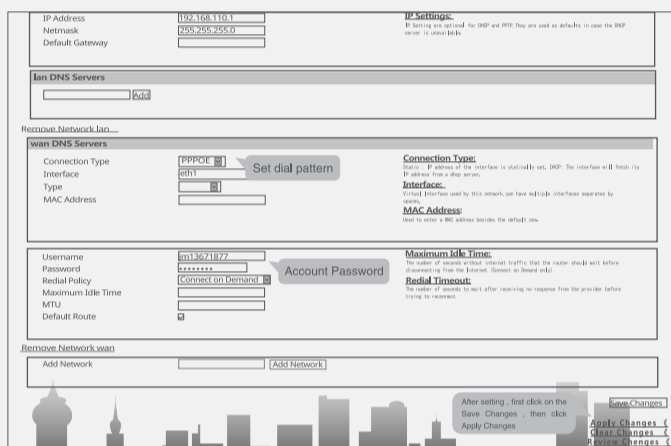

5 Set wireless according to the wireless network.



Interface 6-8

6 Set interface language in System-setting

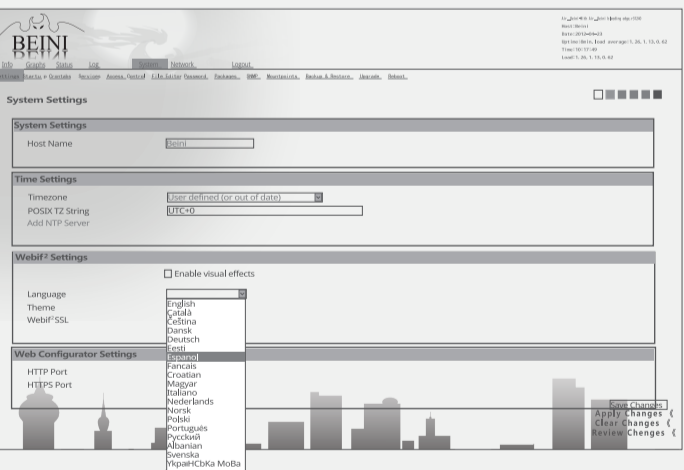

7 Check the operating status of the whole network in Status-interfaces

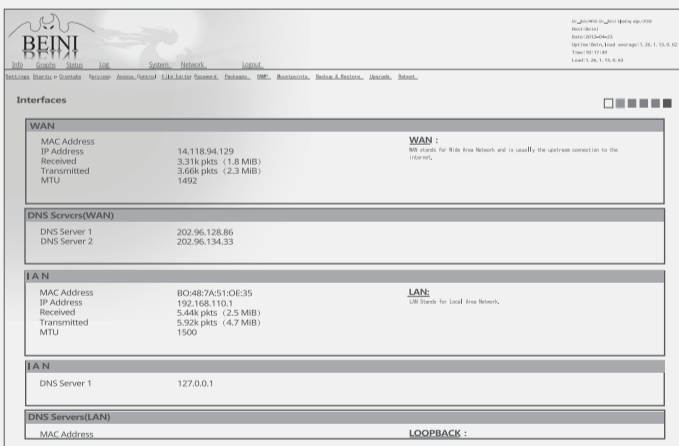

8 Please click "Save changes" after setting every step and click "Apply changes" to save the settings.

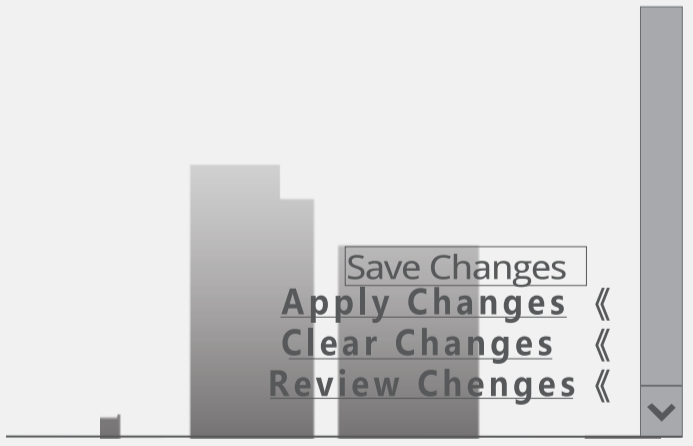

5 Frequently ask questions

1. No reflection after click the key. Most probably, the CUP is high rate operating, click again after 1-2 seconds.
2. Can't sniff pro. The network signal of the other person involved should be in certain strength. It can sniff pro while the router of the other person involved is connecting the wireless network, and it doesn't work while he connects cable network.
3. Can't identify the plug-in USB flash disk. Please change another USB flash disk, because all the genuine brand name USB flash disk can be identified.
4. Can't read the Dictionary. The dictionary's form must be ".TXT". The file must under the root directory of the USB flash disk. Only read the document named after English, can't support other languages.
5. SSID issue after decoded. After decoded, SSID change from Beini to AP XX:XX:XX.
6. After decoded, it can not return to the previous interface when power off. The router will remember the password of the other person involved after decoded. Once the other person involved use the network, you can use it at the same time, and no need to decode again. If you'd like to decode other router, please decode other router according to the status bar.