

***lenovo***

# Lenovo S650

Quick Start Guide v1.0

 Read this guide carefully before using your phone.

# Technical specifications



## Model and system

Model: Lenovo S650

System: Android 4.2



## Size and weight

Height: 138 mm    Width: 69.7 mm    Depth: 8.7 mm

Weight: 126 g



## CPU and capacity

CPU: MT6582V/X Quad Core 1.3 GHz

Capacity: 8 GB



## Camera

Type: CMOS

Pixels: 8.0 MP (back) + 0.3 MP (front)



## Power and battery

Battery: 2000 mAh (Built-in rechargeable lithium-ion battery)



## Display

Size: 4.66 inches (diagonal)

Resolution: 960 × 540

LCD type: IPS



## Wireless communication

Bluetooth 3.0

WLAN

WCDMA, GSM



## GPS

# First Glance

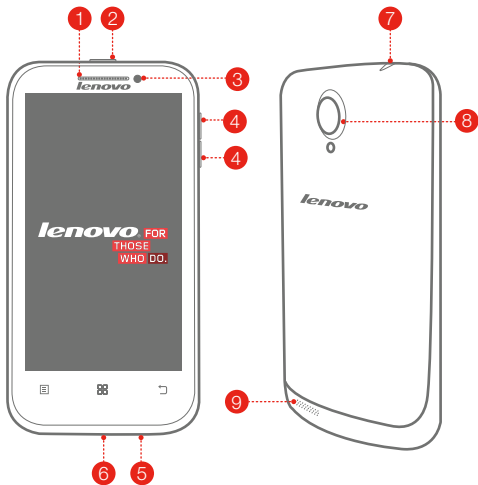

- |                 |                 |                |
|-----------------|-----------------|----------------|
| 1 Receiver      | 2 On/Off button | 3 Front camera |
| 4 Volume key    | 5 Microphone    | 6 Micro USB    |
| 7 Earphone jack | 8 Back camera   | 9 Speaker      |

# Preparing your phone

You need to insert the SIM card provided by your carrier to use cellular services. Install your phone as shown.



**Step 1.** Open the back cover.

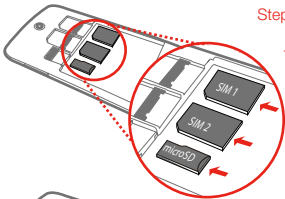

**Step 2.** Insert the SIM cards and the memory card.

**Tip:** Insert (U)SIM card into SIM 1 slot and SIM card into SIM 2 slot.

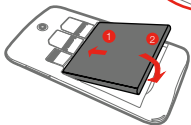

**Step 3.** Install the battery.



**Step 4.** Install the back cover.

**ⓘ** DO NOT insert or remove the SIM cards while your phone is turned on. Doing so can permanently damage your SIM card or your phone.

# Charging the battery

Charge the battery as shown.

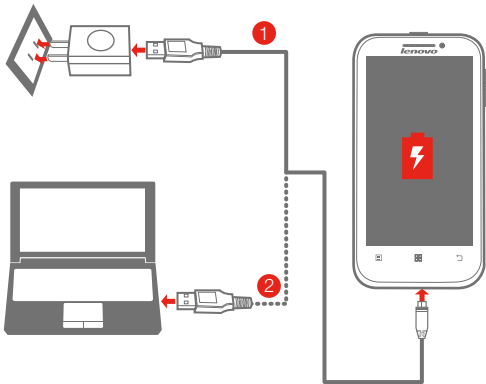

**Method 1.** Connect your phone to a power outlet using the included cable and USB power adapter.

**Method 2.** Charge the battery using a computer.

 Low battery

 Fully charged

 Charging

 For more information about battery safety, see the *Important Product Information Guide*.

## Learn More

For more information about Lenovo Mobile Phone functions, Regulatory Notices and other useful manuals, go to <http://support.lenovo.com/>.

## Legal notices

Lenovo and the Lenovo logo are trademarks of Lenovo in the United States, other countries, or both.

Other company, product, or service names may be trademarks or service marks of others.

First Edition (October 2013)

© Copyright Lenovo 2013.

**Reduce | Reuse | Recycle**



5SC9A4655Y  
Printed in China