

Solar Tire Pressure Monitoring System (TPMS)

User manual

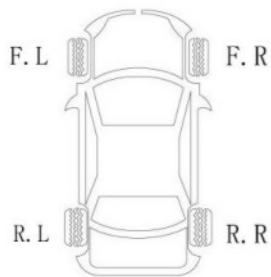

important note:

Please read the instruction manual carefully before use. Pictures and operation introduction of products are only as a reference, all subject to final goods.

Product Overview:

Thank you for purchasing/using our tire pressure monitoring system. This system is designed to provide you with more protection when driving, and it will warn the tire condition of the vehicle in advance.

After installing TPMS, the system can monitor the tire pressure and temperature in real time. If any abnormality in the tire pressure and temperature of the vehicle tire is detected, the system will send a warning sound and flashing icon to inform the driver in real time. Dealing with tire abnormalities in time can avoid traffic accidents and ensure the safety of drivers and passengers.

In addition, the installation of this system can effectively help improve vehicle comfort, enhance driving safety, reduce vehicle wear, reduce fuel consumption and prevent and reduce the chance of tire blowouts.

Please read the manual carefully before using this product. If you have any questions about the description of this manual, please consult the purchasing unit or call customer service.

Button Introduction:

- Receiver charging port
- Left button, Power on/off (Long press)
- Menu button, Enter (Long press at standby mode)
- Right button

1. Button's function:

a. Left button (power button): When the host is turned off, long press the left button to activate the "power on" function, and short press to adjust the screen display brightness; When the host is turned on, long press the left button to turn off the function; When the host enters the setting state, short press the left button to activate the "up/down" function.

b. M key: When the host is turned on, press and hold the M key to enter the "Settings" state; When the host is in the set state, short press the M key to activate the "Select/Confirm" function.

c. Right click (return key): When the host is in the power on state, short press the right button to display the sensor battery voltage (when the battery voltage is below 2.8V, the battery needs to be replaced); When the host is in the set state, short press the right button to activate the "backward/increase" function, and long press to return to the main page.

Tips: In the Settings page, you must long press the right button to return to the main page to shut down

2. Setting function details

A, Change tire pressure unit

Long press "M button" 3 seconds, system will enter setting tire pressure unit options, press "Left / Right" choose "bar / psi" unit, press "M button" save the setting



B, Change tire temperature unit

Long press "M button" 3 seconds, and then press "Right button" 1 time + "M button" 1 times, system will enter setting tire temperature unit options, press "Left / Right" choose C / F unit, press "M button" save the setting.



C, Change alarm value of tire pressure (Defaults: High pressure value 3.1 bar / low pressure value 1.8 bar, high temperature value 68 C)

Long press "M button" 3 seconds, and then press "Right button" 1 times + "M button" 2 times, system will enter

3. Change the upper and lower limits of the tire pressure value

(the factory default is high pressure 3.1 Bar / low pressure 1.8 Bar, high temperature 68 C)

In the standby mode, long press the "menu button" for 3 seconds to

enter the system setting state, and press the "right button" twice to enter the upper air pressure setting

Short press the "menu button" once, the air pressure number flashes, at this time you can use the "left and right buttons" to set the upper limit air pressure, after the setting is completed, long press the "menu button" to exit

In standby mode, long press the "menu button" for 3 seconds to enter the system setting state, press the "right button" 3 times to enter the lower limit setting

Short press the "menu key" once, the air pressure number flashes, set the lower limit of air pressure parameter value through the "left and right keys", after the setting is completed, long press the "menu key" to exit



4. Temperature alarm value adjustment

In the standby mode, long press the "menu button" for 3 seconds to enter the system setting state, press the "right button" 4 times to enter the temperature alarm setting

Press the "menu key" 1 time, the temperature number flashes, at this time, use the "left and right keys" to set the temperature alarm value, after the setting is completed, short press the M key to save.



5. Tire exchange

In the standby mode, long press the "menu key" for 3 seconds to enter the system setting state, continue to press the "right selection key" 5 times to enter the tire exchange mode, short press the "menu key" once to confirm the tire exchange mode, there are two tire icons Keep flashing, short press the left and right "select keys" to enter the tire exchange operation, the default is "left front wheel and right front wheel exchange" state, short press the "left and right selection keys" respectively from "left front wheel and right front wheel exchange" -> "Left rear wheel and right rear wheel exchange" -> "Left front wheel and left rear wheel exchange" -> "Right front wheel and right rear wheel exchange" -> "Right front wheel and left rear wheel exchange" -> "The left rear wheel and the right rear wheel exchange" "select one by one, and press the "menu key" once to confirm in any two-round exchange combination state. The exchange is successful. (Note: 0 means front left wheel/1 means front right wheel/2 means left Rear wheel/3 means right rear wheel)



6. Tyre matching

In the standby mode, long press the "menu key" for 3 seconds to enter the system setting state, continue to press the "right selection key" 6 times to enter the following page, and short press the M key 2 times to enter the 4-round pairing page (4 bars appear on the page),

At this time, you only need to drive the car to 20KM/H, and it can automatically pair



7. Clock adjustment

In the standby state, press and hold the menu key for 3 seconds to enter the system setting state, continue to press the Right Selection key for 7 times to enter the following page, press M to adjust the time, press left and right buttons to adjust the correct time, press M to confirm, and press and hold the right button to exit the setting page.



8. Restore factory Settings

In the standby state, long press "Menu key" for 3 seconds to enter the system setting state, continue to press "Right selection key "7 times to enter the following page. Press the M key to display NO, press the left key to display YES, select whether to restore factory Settings, press the M key to confirm the selection, and long press the right button to exit the setting page.



Parameter of external sensor

Working voltage	2.1V-3.6V
Storage temperature	-30 C—85 C
Working temperature	-40 C—+125 C
Temperature accuracy	±2 C
Working pressure	0-3.5Bar
Pressure accuracy	±0.1Bar
IP	IP67
Transmit power	≤5dBm
Transmit frequency	433.92MHz
Dimension	≥23mm diameter 17mm high
Weight	8.0g

Sensors Installation

External sensor

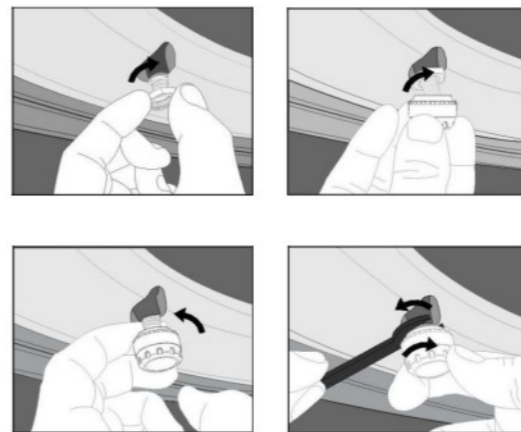

Internal sensor

Internal Sensor Installation

1. Separate tire and rim.
2. Cut off the rubber at the bottom of valve.
3. Use screw to fix valve a bit, remove the washer, nut and dust cap.
4. Mount the sensor on the valve, adjust the best sensor angle in the wheel hub by hand. Remove the sensor from wheel hub, Use a specialized tool to tighten the valve on the same location.

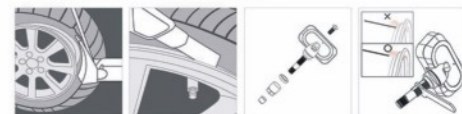

5. After tighten the valve, mount it on the wheel hub.
6. Mount the washer nut and dust cap.
7. Mount the tire and rim, inflate the tire again.
8. Test dynamic balance match balance weight.



External sensor replacement battery

1. Before disassembling the sensor, please prepare a nut wrench, turn the nut clockwise to separate the nut and the sensor, and then remove the sensor counterclockwise;
2. Remove the anti-fixing ring and use a wrench to unscrew the upper cover of the sensor in a counterclockwise direction;
3. Take out the old battery from the battery holder and do a good job of environmental protection classification;
4. Distinguish the position of the positive and negative poles (positive "+" facing up); install a new lithium battery CR1632;
5. Screw on the upper cover of the sensor, and then tighten it clockwise with a wrench.