

Please read the instructions carefully before use

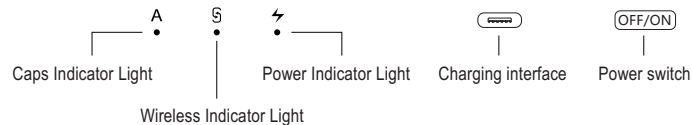

A) A) Bluetooth keyboard case connection operation:

- Turn on the power, the green indicator lights on for 1 second (if the indicator is red, please charge in time)
Press the matching key "Fn+ [Caps Lock]" for 2 second, the Wireless indicator lights flicker into the pairing state, and the effective time is about 120 seconds.
Open the Wireless search function of the external device, click the "Wireless Keyboard" searched.
After the pairing is successful, the indicator lights go out, and you can use the keyboard.
- If it is not in use for 10 minutes, the keyboard will enter auto sleep mode. Please press any keys to wake it up in 2-3 seconds.

B) Three-channel Bluetooth keyboard connection operation:

- Turn on the power, the green indicator lights on for 1 second (if the indicator is red, please charge in time)
Press the pairing key FN + [F1] or [F2] or [F3] hold it for **2 seconds**, and the Bluetooth indicator flashes into the pairing state. The effective time is about 120 seconds. [F1] [F2] [F3] Represents three channels, Pair three channel devices in turn.
Open the Bluetooth search function of external devices, and click the "Wireless Keyboard" found.
After the match is successful, the indicator light goes off, you can use the keyboard.
- If it is not in use for 10 minutes, the keyboard will enter auto sleep mode. Please press any keys to wake it up in 2-3 seconds.
- Press FN + [F1] or [F2] or [F3] to switch the keyboard between three-channel devices. When switching, the Bluetooth light will light up, indicating that the switch is completed.

Note: please refer to the following instructions according to the actual functions of the keyboard: (Partial product support) Please select the input program from the system of the corresponding device, press "FN+And/ Win/ IOS" for 1 seconds to switch, And the bluetooth light will light up when the switch is successful.

Fn+And is converted to Android ; Fn+Win is converted to Windows; Fn+IOS is converted to IOS.

Disconnect the keyboard connection:

- If you want to break the connection between keyboard and device, please clear the pairing information in the device, or turn off the keyboard power directly.

Electricity indicator:

- If the power indicator light is red slowly, the power is low, please charge it in time, the red light is bright when charging. When the indicator is green, it is full, please disconnect the charging power to ensure safety.

Function key: when the key has more than one character or function icon, press Fn or Fn+Shift.

Note: Based on the open source nature of the operating system, different brands of devices may have some function keys inconsistent with the table or unresponsive.

Use unusual characters together with "Option" in IOS. Use "Alt Gr" in WIN/AND.

	WINDOWS	ANDROID	IOS
	Back To Home	Back To Home	Back To Home
	Searching	Searching	Searching
	Email	Email	Virtual Keyboard
	Browser	Browser	Change Input Method
	Screenshots	Screenshots	Screenshots
	Screen Brightness Down	Screen Brightness Down	Screen Brightness Down

	WINDOWS	ANDROID	IOS
	Screen Brightness Up	Screen Brightness Up	Screen Brightness Up
	Back	Back	Back
	Play/pause	Play/pause	Play/Pause
	Forward	Forward	Forward
	Mute	Mute	Mute
	Volume Down	Volume Down	Volume Down
	Volume Up	Volume Up	Volume Up
	Lock Screen	Lock Screen	Lock Screen
	Back	Back	Cancel the input
	Windows	The function keys	CMD=Command
	Lock/Unlock Trackpad	Lock/Unlock Trackpad	Lock/Unlock Trackpad
	Cut	Cut	Cut
	Copy	Copy	Copy
	Paste	Paste	Paste
	Lock the FN key (lock the light flashes twice; Unlock light flashes once)		

Please refer to the following instructions according to the actual functions of the purchased products :

Touch the mouse: Different operating system, gesture command will be different, please refer to the actual situation of the product.

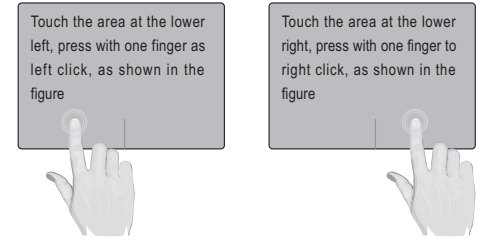
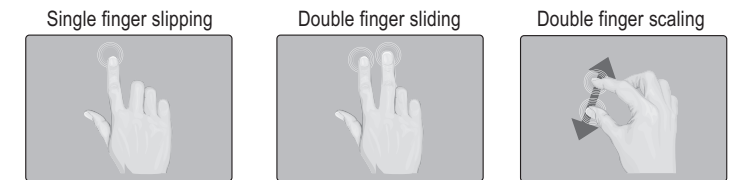

How to adjust the backlit keys:

By pressing (or FN+), you can (turn on/Adjust the brightness/turn off) the luminous function of the keyboard.

If in the off state, press to turn on the luminescence, then press the brightness to increase 20%, then press the brightness to increase 20% again, then press again to turn off the luminescence; Loop through.

FN+ can adjust the luminous color, and switch between different colors in turn.

Note:

If the light can not be lit, or immediately after the light off, please timely charge; If the battery capacity is below 20%, the keyboard will force this function off.

Special notes:

When the battery capacity of the keyboard has a luminous function is 100%, the luminous working time is about 4 to 6 hours (related to brightness); The working time of light off is about 200 hours.

Basic parameters: (part of the parameters are objective factors will vary).

Working Voltage:	3.0V~4.2V	Working Current:	≤3.0mA
Working Time:	≥80 Hours	Low Voltage Alert:	3.0~3.3V
Sleeping Current:	≤0.3mA	Battery Standby Time:	≥100 Days
Battery Capacity:	≥250mAh	Keystrokes:	50g~70g
Keyboard Lifetime:	300 Million Times	Charge Input:	5V, 500mA
Connect Distance:	10m	Charging Time:	2~3 Hours
Charging Current:	150~300mA	Awaken Time:	2~3 Seconds
Charging Port:	TYPE-C	Working Temperatur:	-10°C~+55°C
Matching Password:	No		

Maintenance and warning:

- Do not squeeze or twist, clap the keyboard.
- Do not scan the microwave and get away from the magnetic field.
- Away from the liquid and used in a dry environment.
- Clean the keyboard with soft cloth, do not turn off the power for a long time.
- Other routine maintenance of electronic products.

Common connection Troubleshooting:

- Make sure the power is turned on and the battery is sufficient.
- Make sure that the keyboard is within the range of working distance.
- Make sure that the Wireless related function of the device has been opened.
- Make sure that the keyboard and the device have been paired.
- Clear device pairing record and turn off Wireless function; re match.
- Please do not connect multiple Bluetooth keyboards at the same time; if necessary, please connect one by one.

** This product will not be updated in time for continuous product improvement. If there is any discrepancy, please refer to physical products.

键盘使用说明

** 使用前请仔细阅读操作说明 **

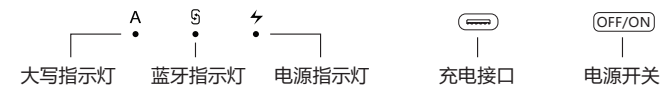

A) 单个通道蓝牙键盘连接操作:

- 1、开启电源，绿色指示灯点亮 1 秒（若指示为红色请及时充电）；
按下配对键 Fn+C/🔗 保持 2 秒蓝牙灯闪烁进入配对状态，有效时间约 120 秒；
此时开启外部设备的蓝牙搜索功能，点击搜索到的“Wireless Keyboard”；
配对成功后指示灯熄灭，即可使用键盘。

- 2、如果在 10 分钟内没有操作，键盘将进入休眠状态，按任意键等待 2~3 秒即可唤醒。

B) 三个通道蓝牙键盘连接操作:

- 1、开启电源，绿色指示灯点亮 1 秒（若指示为红色请及时充电）；
按下配对键 Fn+📶 或者 📶 或者 📶 保持 2 秒，蓝牙指示灯闪烁进入配对状态，有效时间约 120 秒；📶 📶 📶 代表三个通道，请依次配对三个通道设备。
此时开启外部设备的蓝牙搜索功能，点击搜索到的“Wireless Keyboard”；
配对成功后指示灯熄灭，即可使用键盘。
- 2、如果在 10 分钟内没有操作，键盘将进入休眠状态，按任意键等待 2~3 秒即可唤醒。
- 3、按下 Fn+📶 或者 📶 或者 📶 随即松开，即可在三通道设备之间切换使用键盘，切换时蓝牙灯会点亮表示切换完成。

留意：请根据键盘实际功能，查阅如下说明：**(部分产品支持)**
请对应设备的系统选择输入程序，按下“FN+And/ Win/ IOS”保持 1 秒进行切换，切换成功蓝牙灯会点亮指示。
Fn+And 切换到 Android；Fn+Win 切换到 Windows；Fn+IOS 切换到 IOS。

断开键盘连接:

- * 若要断开键盘与设备的连接，请在设备中清除配对的信息，或直接关闭键盘电源。

电量指示:

- * 若电源指示灯为红色慢闪，表示电池电量偏低，请及时进行充电，充电时红灯长亮；当指示灯为绿色时表示充电完成，请断开充电电源确保安全。

功能键: 当按键有多个字符或功能图标时，请按 Fn 或者 Fn+Shift 组合使用。

注意：基于操作系统的开源性，不同品牌设备可能存在部分功能键与表格所示不一致或者无反应。
不常规字符在 IOS 系统请配合 Option 使用，在 WIN/AND 系统请配合 Alt Gr 使用。

	WINDOWS	ANDROID	IOS
□	主界面	主界面	主界面
🔍	搜索	搜索	搜索
✉	邮件	邮件	虚拟键盘
🌐	浏览器	浏览器	切换输入法
📄	截屏	截屏	截屏
☀	减少亮度	减小亮度	减小亮度
☀	增加亮度	增加亮度	增加亮度
⏮	前一首	前一首	前一首
⏸	播放暂停	播放暂停	播放暂停
⏭	后一首	后一首	后一首

	WINDOWS	ANDROID	IOS
🔇	静音	静音	静音
🔊	减小音量	减小音量	减小音量
🔊	增加音量	增加音量	增加音量
🔒	锁屏	锁屏	锁屏
↶	返回	返回	撤消输入
Win	Windows	功能键	CMD=Command
🖱	停用滑鼠	停用滑鼠	停用滑鼠
✂	剪切	剪切	剪切
📄	复制	复制	复制
📄	粘贴	粘贴	粘贴
🔒	锁定 Fn 键（锁定灯闪 2 次；解锁灯闪 1 次）		

请根据所购产品实际功能，查阅如下说明:

触摸滑鼠: 适配不同的操作系统，手势命令会有所差别，请以产品实际情况为准。

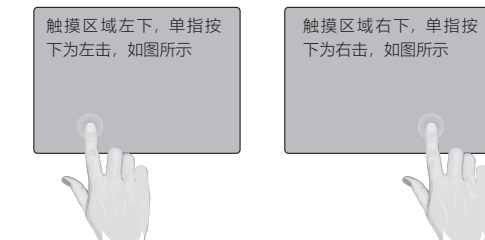

有此图标表示键盘支持发光功能:

按下此图标键 (或者 FN+💡), 可以 (开启 / 调节 / 关闭) 键盘的发光功能。
如果在关闭状态，按一下为开启发光，再按一下亮度加强约 20%，再按一下亮度再次加强约 20%，再次按下即可关闭发光；依次循环。

FN+🎨 可以调节发光颜色，依次在不同的颜色之间循环切换。

注意:

如果发光无法点亮，或在点亮后即刻关闭，请及时充电；电池容量低于 20% 时，键盘会强制关闭此功能。

说明:

键盘有发光功能的电池容量为 100% 时，开启发光工作时间约为 4~6 小时 (与亮度有关)；关闭发光工作时间约为 200 小时。

基本参数: (部分参数存在客观因素会有所差异)

工作电压:	3.0V~4.2V	工作电流:	≤3.0mA
工作时长:	≥80小时	低电报警:	3.0~3.3V
休眠电流:	≤0.3mA	待机时长:	≥100天
电池容量:	≥250mAh	按键力度:	50g~70g
按键寿命:	300万次	充电输入:	5V, 500mA
连接距离:	10m	充电时长:	2~3小时
充电电流:	150~300mA	唤醒时长:	2~3秒
充电接口:	TYPE-C	工作温度:	-10°C~+55°C
配对密码:	无		

维护与警告:

- * 不要挤压或扭曲、拍打键盘。
- * 不要进行微波扫描，远离磁场。
- * 远离液体，并在干燥环境中使用。
- * 用软布清洁键盘，长期不用请关闭电源。
- * 不要随意丢弃键盘，请按类别回收放置。

常见连接故障排除:

- * 确保电源已开启，且电池电量充足。
- * 如果多次无法充电，请尝试更换充电线。
- * 确保键盘在工作距离范围内。
- * 确保设备蓝牙相关功能已开启。
- * 确保键盘和设备已经配对连接。
- * 清除设备的配对记录，并关闭蓝牙功能；再重新配对，必要时重启设备。
- * 请不要同时配对连接多个蓝牙键盘；如有需要请逐个连接。

** 产品持续改进中，此说明书不一定会及时更新，如有差异，请以实物产品为准 **