



# **Smart camera**

# **Instruction**

2022/6/27 update

# Download Yi IoT app

Scan QR code below



Search and download

Yi IoT app

In Google play

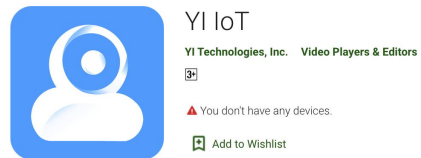

In App store



# Sign up and log in

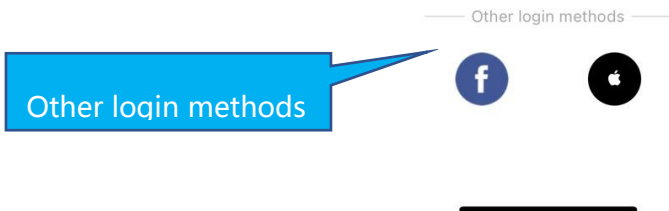
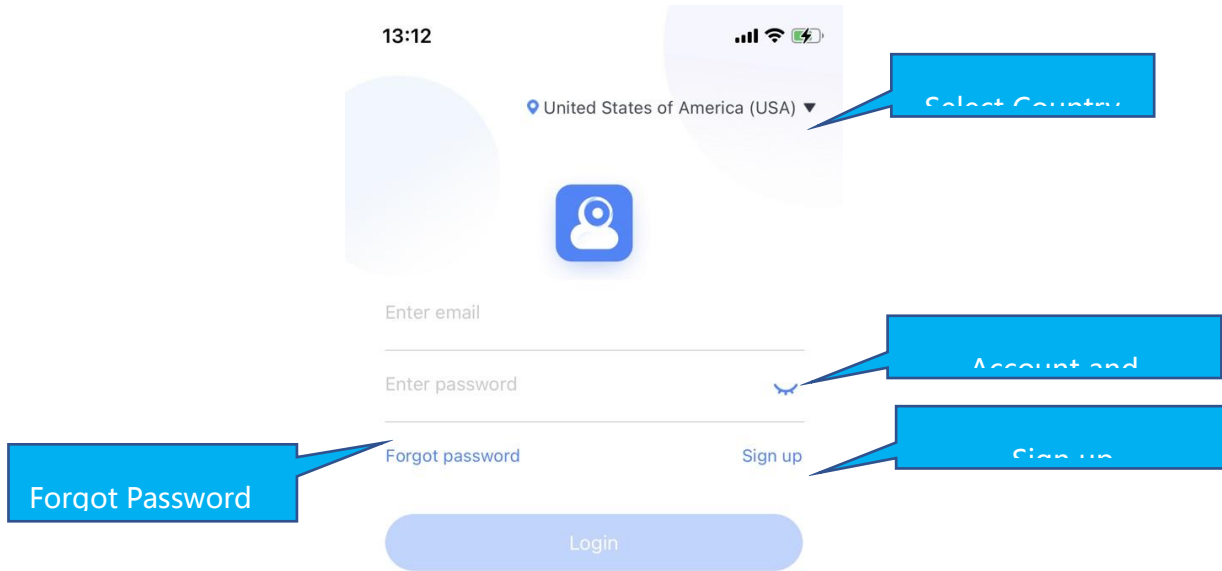

# How to add camera

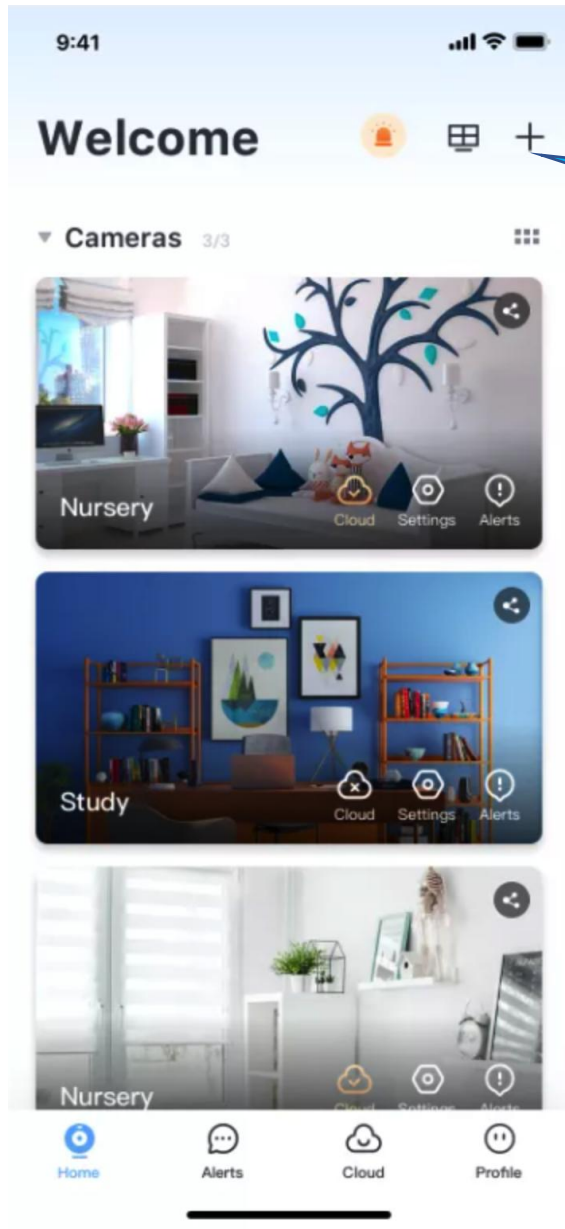

Click add button

# How to connected with Wi-fi

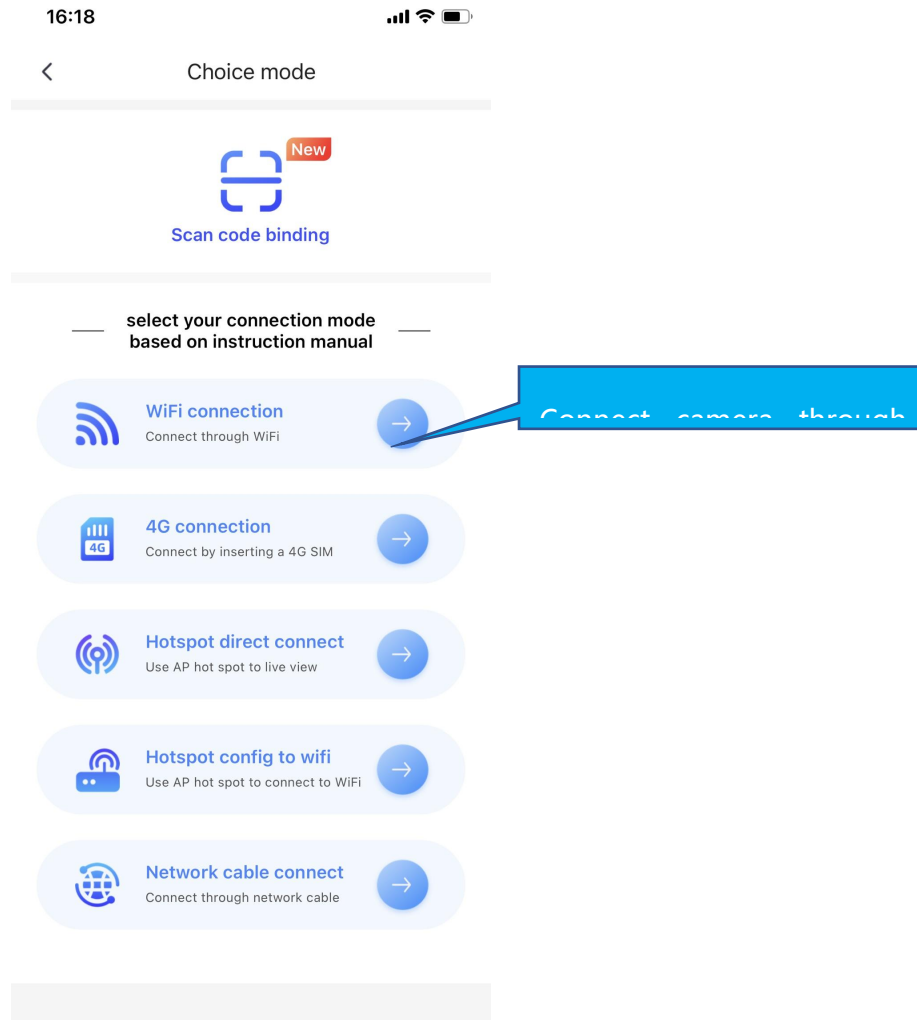

13:16



Adding Camera



Wait 20 seconds until you hear a two-tone sequence.

I heard the beep

Check the button

Next

[? If you did not hear anything, tap here.](#)

---

If you don't hear the sequence, please press the "RESET" on the device. Continue for more than 5 seconds, until you heard the sequence, that means the reset is successful.

14:18



Connect to WiFi

SeeDifferent\_SZ Change network

Please enter password 👁

Save password

connected to wifi in mobile

Next

🔒 Minimum network requirement



Note:

1. 5GHz wireless band is not supported;
2. Please turn on location of phone

16:20



< QR code faces camera directly



If the scan is unsuccessful for a long time, please click QR code to enlarge and try again



Please adjust the distance to make the scan successful.

I heard "Waiting to connect"  
If you hear tips, press next

Check the button

Next

[🔗 If you did not hear anything, tap here.](#)

The QR code that appears on the mobile phone is scanned against the camera lens, and the device emits a prompt sound "QR code scan successful" and "WiFi connected", check "I heard waiting to connect" button, and click "Next", wait for the network configuration to be completed.



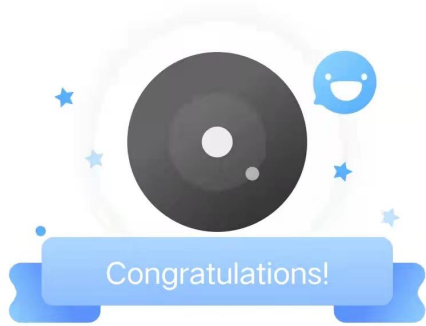

Doing successful

Camera name

Smart Camera

- Living room
- Bedroom
- Kitchen
- Garden
- babyroom
- Office

FINISH

# How to use app

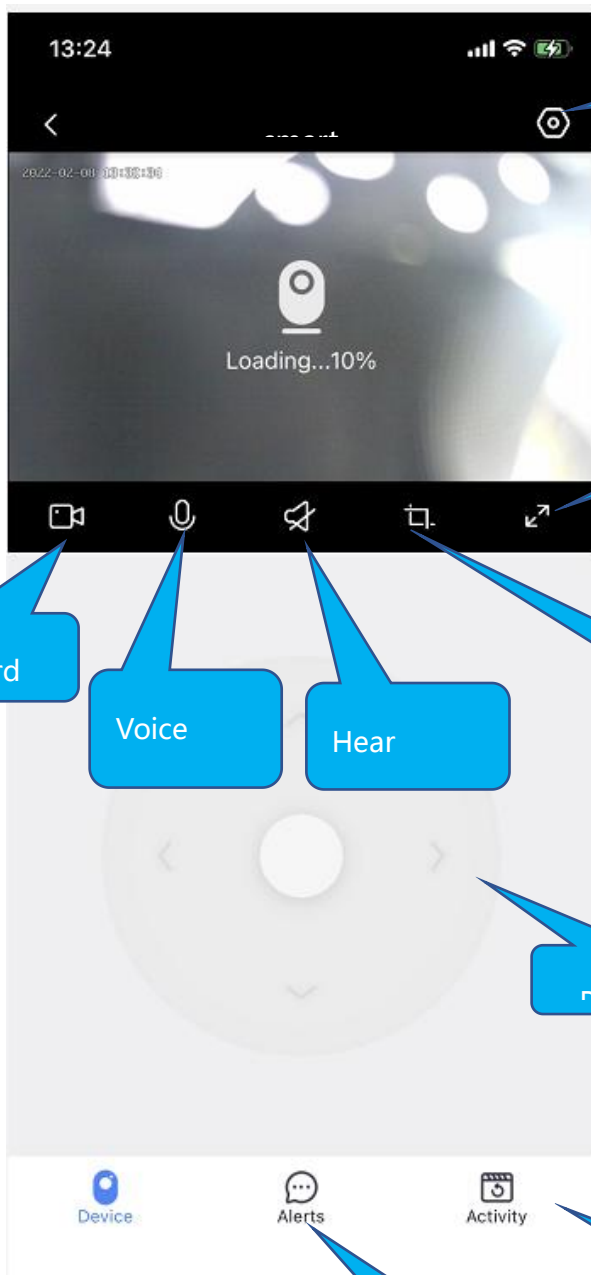

Camera settings

Full screen

Local record

Voice

Hear

Local

DT7 control

Playback

Alert messages



< 2022-01-24 >

Alert clip



Smart 15:02  
Motion Detected

Alert



Smart 14:59  
Motion Detected



Smart 14:55  
Motion Detected

Device

Alerts

Activity

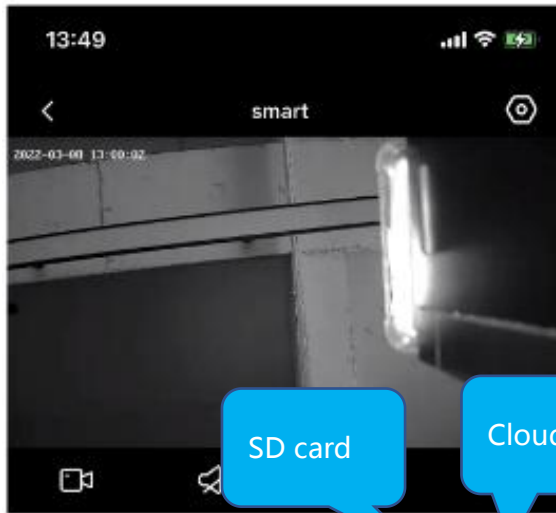

SD card

Cloud

Select

Select

Activity  
From SD card

03/05 03/06 03/07 03/08

11:00 12:00 13:00 14:00

Device Alerts Activity

A screenshot of the "Activity" screen in the smart camera app. The title "Activity" is followed by "From SD card". Below this is a timeline view showing dates from 03/05 to 03/08. A blue bar highlights a specific time range on 03/08, from 11:00 to 13:00. At the bottom, there are three icons: "Device", "Alerts", and "Activity", with "Activity" being the active selection.

# Cloud storage

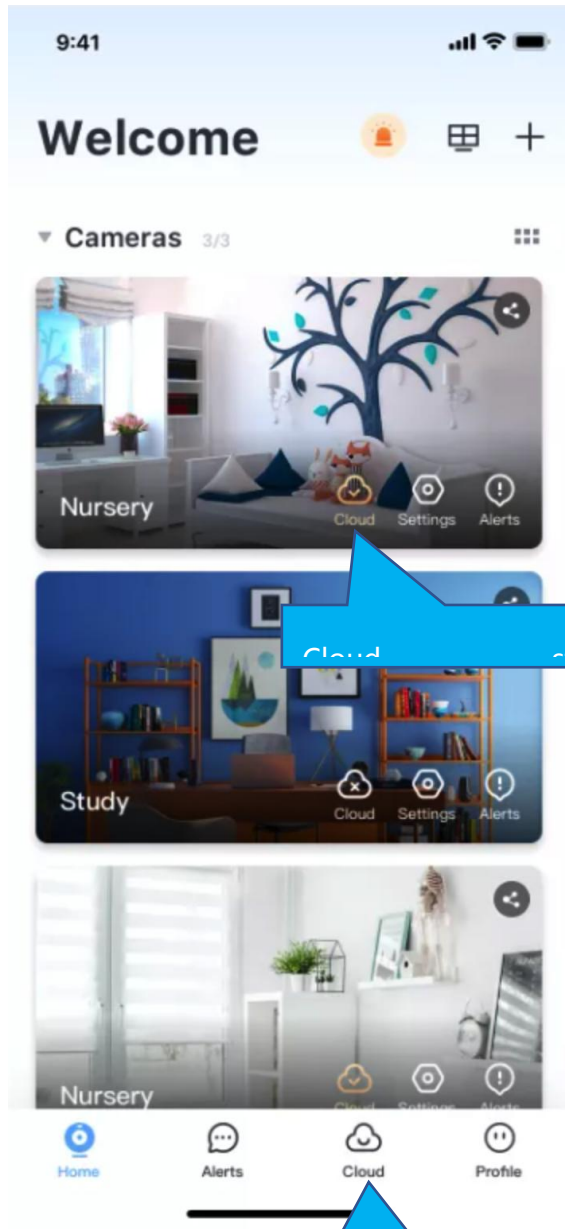

Cloud storage

# Common problem

Q: The camera is offline or offline

1. Check if the power supply is working properly
2. Power off and restart the device to reconnect to the network
3. The signal coverage is weak
4. Signal interference shielding in special places

Q: How does the camera store video

1. The camera supports the F32 format with a maximum capacity of 64G. After the card is recognized, it automatically records, and when the storage is full, it automatically overwrites the original recording and loops recording;
2. Support opening cloud storage service to store video;

# Special statement

The product is subject to the actual product, the instruction manual is for reference only

Mobile phone app and device firmware version support update, users can upgrade through the app.

The manual may contain technical descriptions or inconsistencies with product functions or typographical errors. Please understand, please refer to the final interpretation of our company.

Do not install the product in a place where it is damp, dusty, high temperature, flammable or explosive and out of reach of children.